

# FIRE PUMP TEST METER K-1500-10

## CONSTRUCTION & SPECIFICATIONS

MATERIALS:	CA36 ASTM B16 BRASS
VALVES:	RATED AT 600 WOG
	VALVE BODY: CAST BRONZE ASTM B584
	TAIL PIECE: CA-360 B-16
	BALL: BRASS CA-360 HARD CHROME P
	LATED SEALS: REINFORCED PTFE, 15%
	GLASS FILLED HANDLE: STEEL ASTM B633
	W/ZINC PLATING
BRASS FITTING:	PIPE NIPPLE - B16 / 1/8" NEEDLE VALVE-B16
	DISCONNECTS-B16
ID TAG:	CHAIN: BRASS
	TAG: ALUMINUM -3.21" THICK #200 MILL
	SET SCREW: STEEL ZINC PLATED
HOSES:	GOODYEAR 3/16" FREON CHARGING HOSES
	WITH NYTRIEE CORE, POLYESTER BRAID
	AND NYTRILE COVER WITH PVC
	FOR ABRASION RESISTANCE.

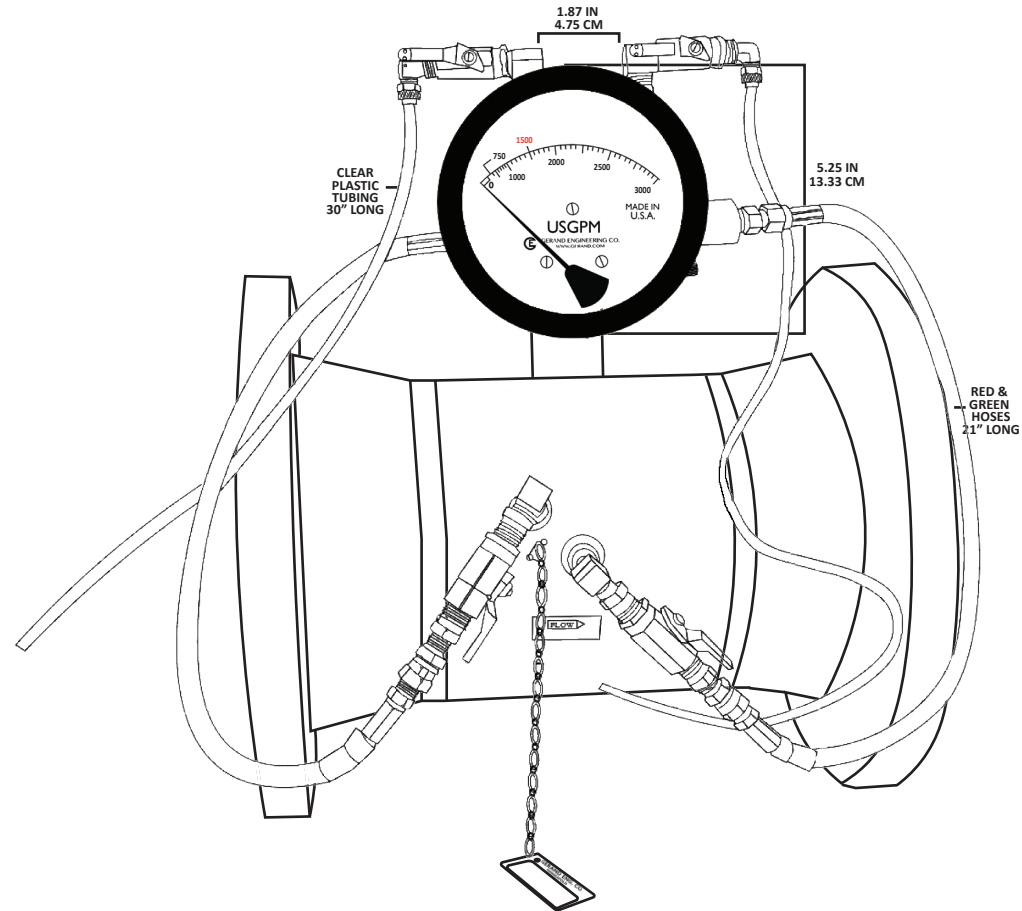

## METER DATA

CONSTRUCTION:	ALUMINUM BODY
OPERATION:	BUNA "N" DIAPHRAGM
ACCURACY:	±2.0%
TEMPERATURE:	200° F MAX
PRESSURE:	1500 PSI MAX
APPROX.WEIGHT:	3 LBS/EACH

4 1/2" DIAL STANDARD - 6" AVAILABLE

WELD-NECK FLANGES  
RAISED FACE

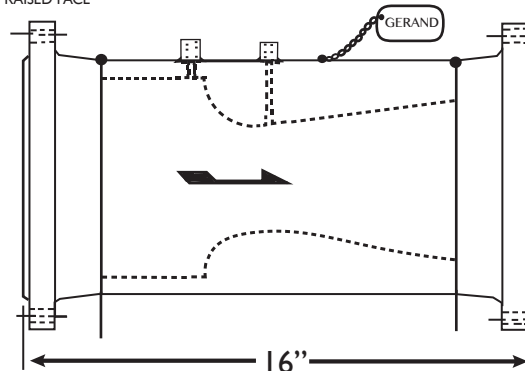

## WEIGHTS & DIMENSIONS

WEIGHT:	181 LBS
SHIPPING DIMENSIONS:	33" x 33" x 29" with PALLET