



# GERAND ENGINEERING

9431 SCIENCE CENTER DRIVE, NEW HOPE MN 55428  
952.374.1320 WWW.GERAND.COM

## FIRE PUMP TEST METER G-500-5

### CONSTRUCTION & SPECIFICATIONS

VENTURI: ZINC PLATED STEEL

VALVES: ONE PIECE BRASS BODY  
ZINC DIECAST STEEL HANDLE

HOSES: 3/16" NYTRILE CORE, POLYESTER BRAID  
AND EPDM SYNTHETIC COVER

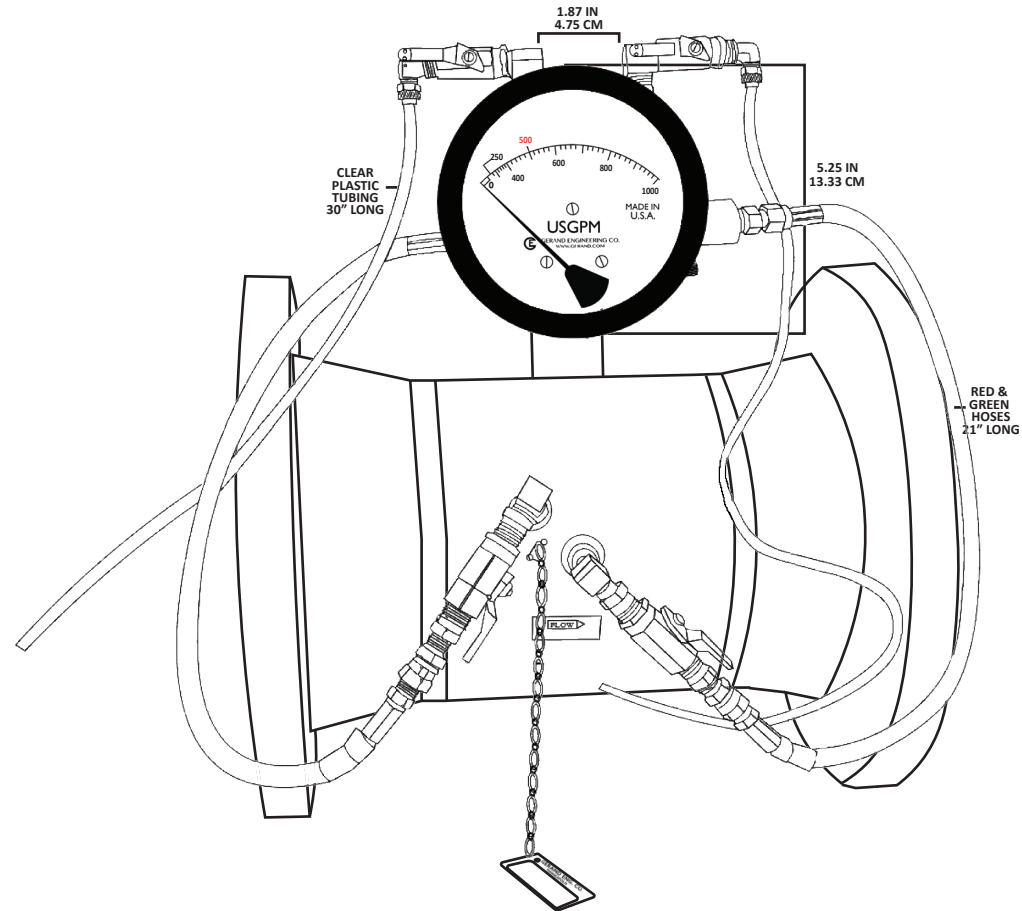

### METER DATA

CONSTRUCTION: ALUMINUM BODY

OPERATION: BUNA "N" DIAPHRAGM

ACCURACY:  $\pm 2.0\%$

TEMPERATURE: 200° F MAX

PRESSURE: 1500 PSI MAX

APPROX. WEIGHT: 3 LBS/EACH

4 1/2" DIAL STANDARD - 6" AVAILABLE

WELD-NECK FLANGES  
RAISED FACE

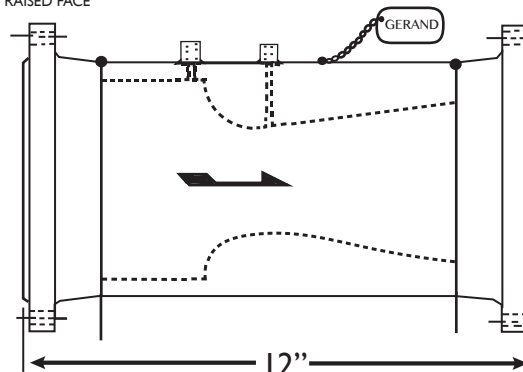

### WEIGHTS & DIMENSIONS

WEIGHT: 55 LBS

SHIPPING  
DIMENSIONS: 13" x 13" x 21" BOX